



HAMMERS AND BITS
Patriot® 85Q
Down Hole
Hammer

FEATURES

- Valveless down hole hammer design
- Designed to operate at pressures up to 500 PSI (34.5 BAR)
- Hardened, non-reversible, non-ported case for extended life
- Delivers more energy per blow which results in higher penetration rates in hard rock
- For use in any hard rock application

AIR CONSUMPTION

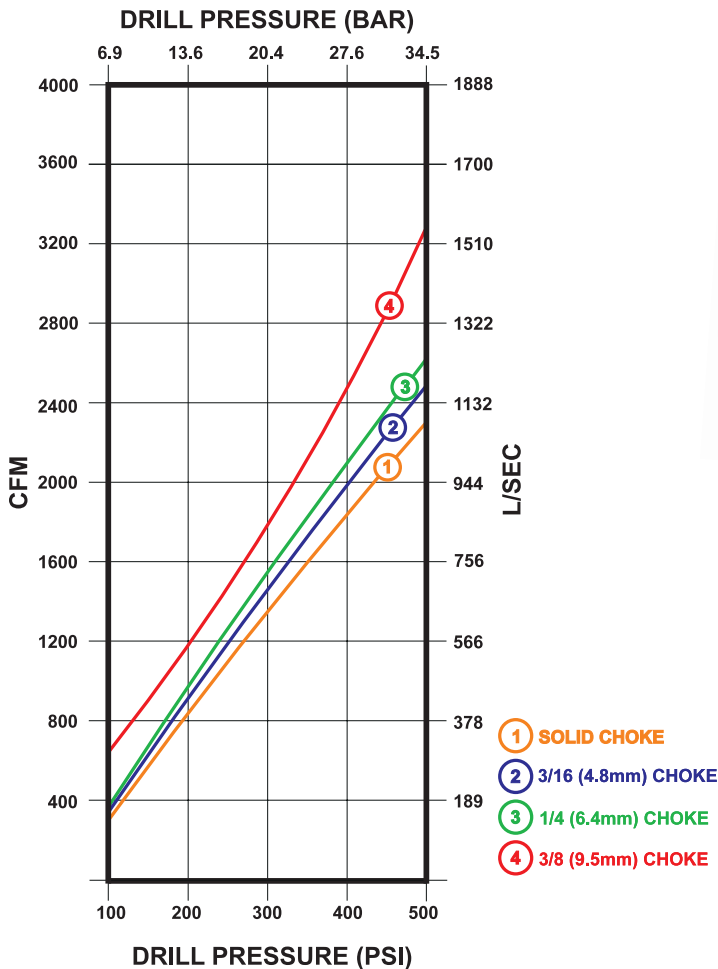

SPECIFICATIONS

Diameter	7-1/8"	181 mm
Bore	6"	152 mm
Stroke	3-3/4"	95 mm
Weight (Hammer only)	406 lbs.	184 kg
Length (Shoulder to Shoulder)	51-1/4"	130 cm
Length (Shoulder to Bit Face)	56"	142 cm
A.P.I. Reg. Threads	4-1/2	

- 1600 blows per minute at 350 PSI (23.8 BAR)
- Drills holes from 7-7/8" to 10" (200 mm - 254 mm) in diameter
- Accepts QL80 bit shank



Down Hole Button Bits

Patriot® 85Q

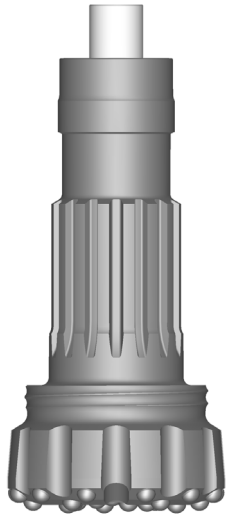

QL80 Bit Shank

DIAMETER
inches (millimeters)

WEIGHT*
pounds (kilograms)

FACES AVAILABLE

7-7/8"	(200 mm)	107 lbs.	(48.5 kg)
8"	(203 mm)	108 lbs.	(48.9 kg)
8-1/2"	(216 mm)	114 lbs.	(51.7 kg)
8-5/8"	(219 mm)	115 lbs.	(52.2 kg)
8-3/4"	(222 mm)	116 lbs.	(52.6 kg)
8-7/8"	(225 mm)	117 lbs.	(53.1 kg)
9"	(229 mm)	122 lbs.	(55.3 kg)
10"	(254 mm)	127 lbs.	(57.6 kg)

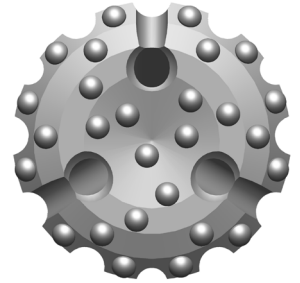

Concave

* Bit weights are approximate

FEATURES

- 3/4" (19 mm) diameter carbide buttons throughout face
- Chipways designed for faster hole cleaning
- Carbide buttons positioned for better fracture of rock providing faster penetration rates
- Several grades and types of carbide are available
- Other bit sizes and carbide may be available upon request

For More Information Contact:

646 Thompson Road • Thompson, CT 06277 USA
 Phone: (860) 923-9551 • Fax: (860) 923-2617
numa@numahammers.com • www.numahammers.com

